

Event Log Dump SD Card

Scientific working for MIRUS Controller

CE 0044

Art.No. MC-01-016
MIRUS Event Log Dump Step by Step | C.00
Page/Seite/Pagina 1/2

Step-by-Step MIRUS Event Log Dump / Schritt-für-Schritt Anleitung

MIRUS Event Log sichern / Instructions étape par étape de télécharger Event Log MIRUS /

Istruzione passo per passo per scaricare MIRUS Event Log



GB
Caution:
Read before use.

DE
Warnung:
Vor Gebrauch lesen.

FR
Attention:
Lisez d'abord ceci.

IT
Attenzione:
Leggi questo prima.

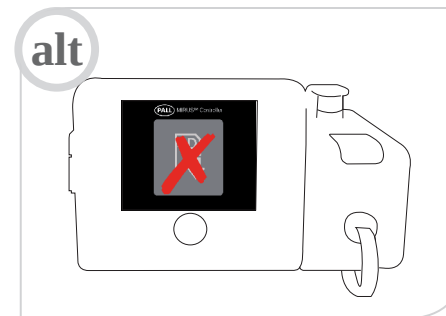
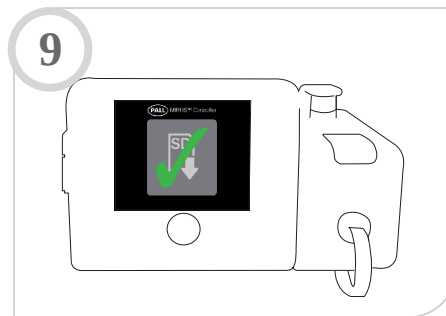
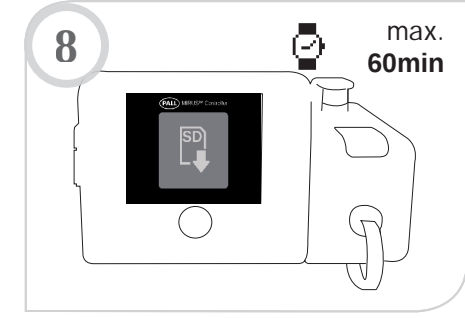
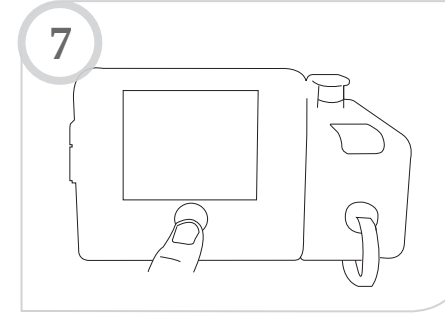
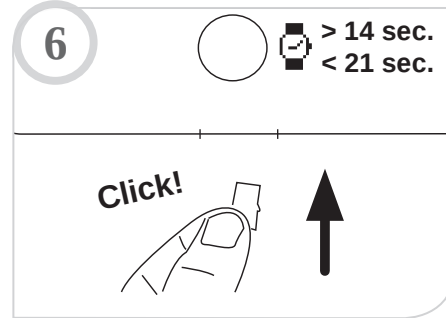
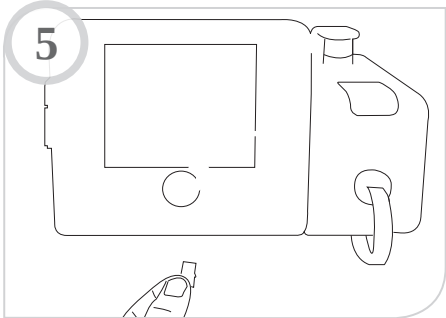
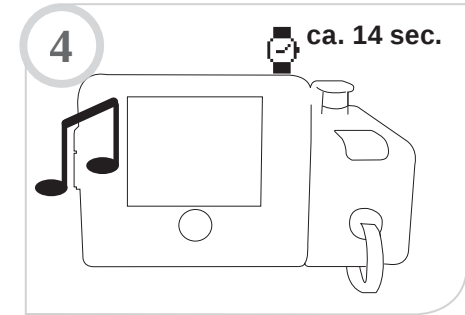
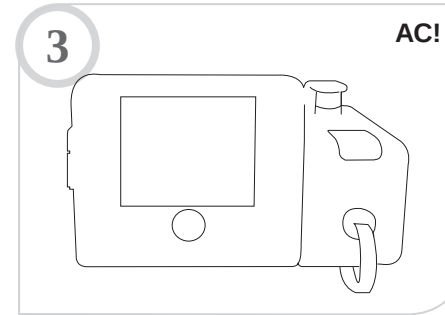
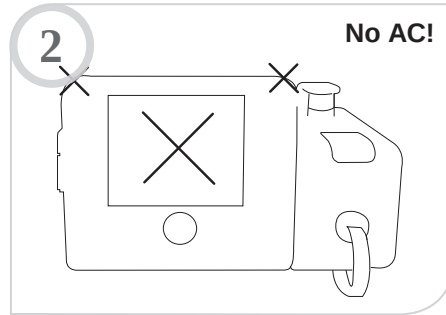
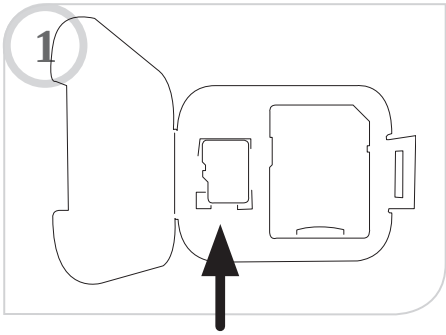

Event Log Dump SD Card

Scientific working for MIRUS Controller

 Technologie Institut Medizin GmbH (TIM)
Erfurter Straße 9 | D-56626 Andernach, Germany
T.: +49 (0) 2632 987 629 7 | info@tim-gmbh.de

CE 0044

Art.No. MC-01-016
MIRUS Event Log Dump Step by Step | C.00
Page/Seite/Pagina 2/2

Step-by-Step MIRUS Event Log Dump / Schritt-für-Schritt Anleitung

MIRUS Event Log sichern / Instructions étape par étape de télécharger Event Log MIRUS /

Istruzione passo per passo per scaricare MIRUS Event Log



GB
Caution:
Read before use.

DE
Warnung:
Vor Gebrauch lesen.

FR
Attention:
Lisez d'abord ceci.

IT
Attenzione:
Leggi questo prima.

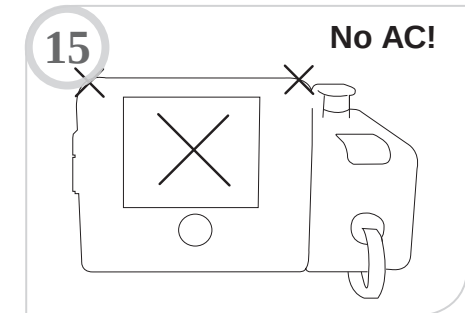
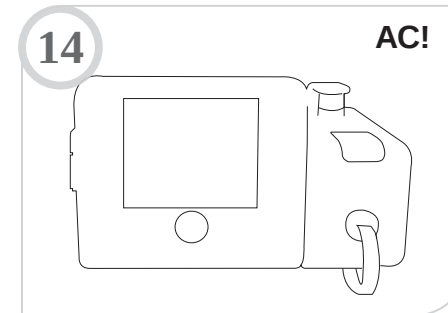
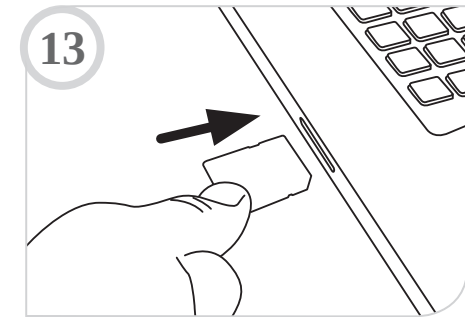
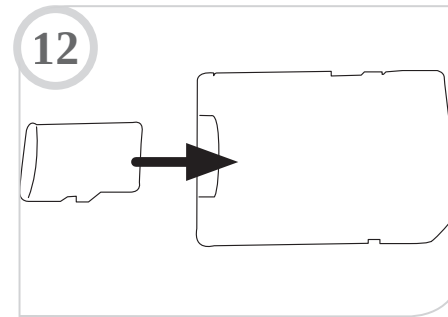
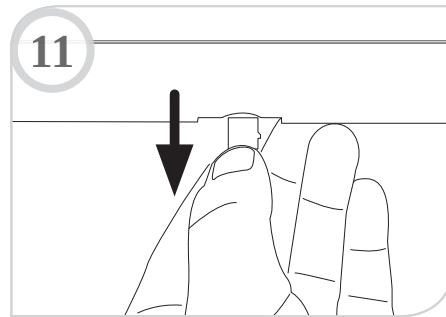

Zip & Email data to/ Gezippte Daten per Email an/ Envoyer data zip-comprimé à /

Comprimere i dati e invia a e-mail:

mirus@tim-products.de

In Demo Pool: Use μ SD Card Adapter also for MC! Pictures alike.

Bei Demo Pool Geräten: μ SD Card Adapter auch mit dem MC nutzen. Abbildung ähnlich.

Utilisez l'adaptateur de carte μ SD avec le MC Demo Pool. Illustration similaire.

Nei dispositivi Demopool: Utilizzare μ SD adattatore della carta con il MC. Simile a immagine.